



**first
national**
REAL ESTATE

| Mark Gunther

**We
put
you
first**

STATEMENT OF INFORMATION

13 BLUEGUM DRIVE, BADGER CREEK, VIC 3777

PREPARED BY MARK GUNTHER, FIRST NATIONAL REAL ESTATE MARK GUNTHER



STATEMENT OF INFORMATION

Section 47AF of the Estate Agents Act 1980

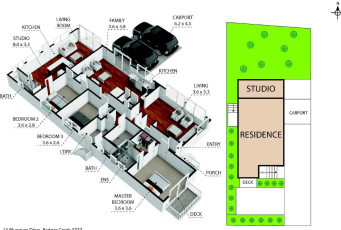

13 BLUEGUM DRIVE, BADGER CREEK, VIC 🛏️ 3 🍷 3 🚗 2

Indicative Selling Price

For the meaning of this price see consumer.vic.au/underquoting

Price Range: **\$700,000 to \$770,000**

Provided by: Mark Gunther, First National Real Estate Mark Gunther

MEDIAN SALE PRICE

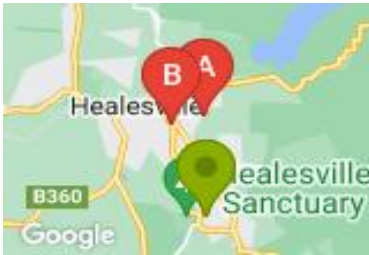

BADGER CREEK, VIC, 3777

Suburb Median Sale Price (House)

\$722,500

01 April 2023 to 31 March 2024

Provided by: pricefinder

COMPARABLE PROPERTIES

The estate agent or agent’s representative reasonably believes that fewer than three comparable properties were sold within two kilometres of the property for sale in the last six months.



73 THOMAS RD, HEALESVILLE, VIC 3777

🛏️ 4 🍷 2 🚗 2

Sale Price

\$760,000

Sale Date: 15/02/2023

Distance from Property: 2.9km



56A BADGER CREEK RD, HEALESVILLE, VIC

🛏️ 4 🍷 2 🚗 1

Sale Price

\$750,000

Sale Date: 25/01/2023

Distance from Property: 2.8km

Statement of Information

Single residential property located in the Melbourne metropolitan area

Sections 47AF of the Estate Agents Act 1980

Instructions: The instructions in this box do not form part of this Statement of Information and are not required to be included in the completed Statement of Information for the property being offered for sale.

The Director of Consumer Affairs Victoria has approved this form of the Statement of Information for section 47AF of the *Estate Agents Act 1980*.

The estate agent or agent's representative engaged to sell the property is required to prepare this Statement of Information. It must be used when **a single residential property located in the Melbourne metropolitan area** is being offered for sale. The Determination setting out the local government areas that comprise the Melbourne metropolitan area is published on the Consumer Affairs Victoria website at **consumer.vic.gov.au/underquoting**. The indicative selling price in this Statement of Information may be expressed as a single price, or as a price range with the difference between the upper and lower amounts not more than 10% of the lower amount.

This Statement of Information must be provided to a prospective buyer within two business days of a request and displayed at any open for inspection for the property for sale.

It is recommended that the address of the property being offered for sale be checked at services.land.vic.gov.au/landchannel/content/addressSearch before being entered in this Statement of Information.

Property offered for sale

Address
Including suburb and
postcode

13 BLUEGUM DRIVE, BADGER CREEK, VIC 3777

Indicative selling price

For the meaning of this price see consumer.vic.gov.au/underquoting

Price Range: \$700,000 to \$770,000

Median sale price

Median price \$722,500

Property type

House

Suburb

BADGER CREEK

Period 01 April 2023 to 31 March 2024

Source



Comparable property sales

The estate agent or agent's representative reasonably believes that fewer than three comparable properties were sold within two kilometres of the property for sale in the last six months.

Address of comparable property

Price

Date of sale

73 THOMAS RD, HEALESVILLE, VIC 3777	\$760,000	15/02/2023
56A BADGER CREEK RD, HEALESVILLE, VIC 3777	\$750,000	25/01/2023

This Statement of Information was prepared on:

01/05/2024