

Statement of Information

Single residential property located in the Melbourne metropolitan area

Section 47AF of the Estate Agents Act 1980

Property offered for sale

Address
Including suburb and
postcode

2 Hillingdon Place, Prahran Vic 3181

Indicative selling price

For the meaning of this price see consumer.vic.gov.au/underquoting

Range between \$910,000 & \$1,000,000

Median sale price

Median price \$1,555,000 Property Type House Suburb Prahran

Period - From 01/01/2023 to 31/03/2023 Source REIV

Comparable property sales (*Delete A or B below as applicable)

~~A* These are the three properties sold within two kilometres of the property for sale in the last six months that the estate agent or agent's representative considers to be most comparable to the property for sale.~~

	Address of comparable property	Price	Date of sale
1	10a Phoenix St SOUTH YARRA 3141	\$1,010,000	10/02/2023
2			
3			

OR

B* The estate agent or agent's representative reasonably believes that fewer than three comparable properties were sold within two kilometres of the property for sale in the last six months.

This Statement of Information was prepared on:

03/07/2023 12:04

2 HILLINGDON PLACE, PRAHRAN



Rooms: 4
Property Type: Townhouse
 (Single)
 Agent Comments

Indicative Selling Price
 \$910,000 - \$1,000,000
Median House Price
 March quarter 2023: \$1,555,000

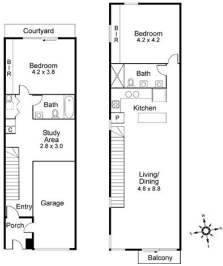

Comparable Properties



10a Phoenix St SOUTH YARRA 3141 (REI/VG) Agent Comments



Price: \$1,010,000
Method: Private Sale
Date: 10/02/2023
Property Type: Townhouse (Res)
Land Size: 73 sqm approx

The estate agent or agent's representative reasonably believes that fewer than three comparable properties were sold within two kilometres of the property for sale in the last six months.

Account - BigginScott | P: 03 9426 4000