

Statement of Information

Single residential property located outside the Melbourne metropolitan area

Section 47AF of the Estate Agents Act 1980

Property offered for sale

Address
Including suburb or
locality and postcode

28 Berrigan Drive, Bonshaw Vic 3352

Indicative selling price

For the meaning of this price see consumer.vic.gov.au/underquoting

Range between

\$475,000

&

\$505,000

Median sale price

Median price

\$545,000

Property Type

House

Suburb

Bonshaw

Period - From

01/04/2023

to

31/03/2024

Source

REIV

Comparable property sales (*Delete A or B below as applicable)

~~A* These are the three properties sold within five kilometres of the property for sale in the last eighteen months that the estate agent or agent's representative considers to be most comparable to the property for sale.~~

	Address of comparable property	Price	Date of sale
1	8 Marrubak Way BONSHAW 3356	\$500,000	13/05/2024
2	19 Dante Cr BONSHAW 3352	\$470,000	05/06/2024
3			

OR

B* The estate agent or agent's representative reasonably believes that fewer than three comparable properties were sold within five kilometres of the property for sale in the last eighteen months.

This Statement of Information was prepared on:

11/06/2024 14:28

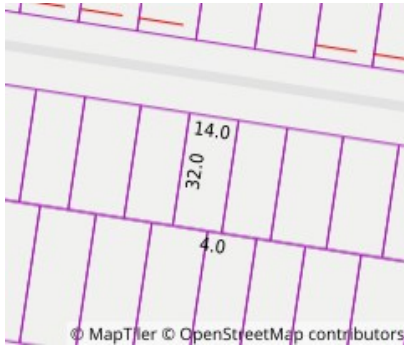

4 2 2

Rooms: 2
Property Type: House (Res)
Land Size: 448 sqm approx
[Agent Comments](#)

Indicative Selling Price
\$475,000 - \$505,000
Median House Price
Year ending March 2024: \$545,000

Comparable Properties



8 Marrubak Way BONSHAW 3356 (REI)

[Agent Comments](#)

4 2 2

Price: \$500,000
Method: Private Sale
Date: 13/05/2024
Property Type: House



19 Dante Cr BONSHAW 3352 (REI)

[Agent Comments](#)

4 2 2

Price: \$470,000
Method: Private Sale
Date: 05/06/2024
Property Type: House

The estate agent or agent's representative reasonably believes that fewer than three comparable properties were sold within five kilometres of the property for sale in the last eighteen months.

Account - Jellis Craig | P: 03 5329 2500 | F: 03 5329 2555