

WOODTREE RESIDENCES

Fact Sheet

ADDRESS	249-253 Ashmore Road, Benowa
DEVELOPER	Astracorp
ARCHITECT	Archidiom
BUILDER	Bradwell Constructions
BODY CORPORATE	\$50 - \$60 p/w
ANTICIPATED COMPLETION	Q4 2022
DA STATUS	Approved
NUMBER OF APARTMENTS	39
NUMBER OF LEVELS	4
CEILING HEIGHTS	2.4m
NUMBER OF LIFTS	2
FACILITIES	Rooftop BBQ Area, Yoga Lawn
METERS	Separate
COOKTOP	Electric
FLOORING	Timber Look Vinyl Plank, Carpet & Tile
AIR-CONDITIONING	Reverse Cycle
INITIAL DEPOSIT AMOUNT	\$2,000

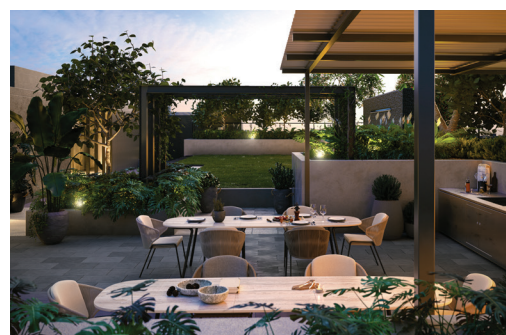

SGP

SUTHERLANDgroup
PROPERTY

3/46 Thomas Drive
Chevron Island, Gold Coast QLD 4217

1300 798 729
info@sutherlandgroup.com.au
www.sutherlandgroup.com.au