



CONTRACT DRAWINGS
 These are the specifications and plans referred to in the Building Agreement.
 Dated:
 Signed By:
 Signed Purchased:

08
S&R

08
S&R

FLOOR PLAN 1:100



DOUBLE RAIL • 1050MM H
 * TOWEL RING • 1050MM H
 * TOILET ROLL HOLDER • 750MM H

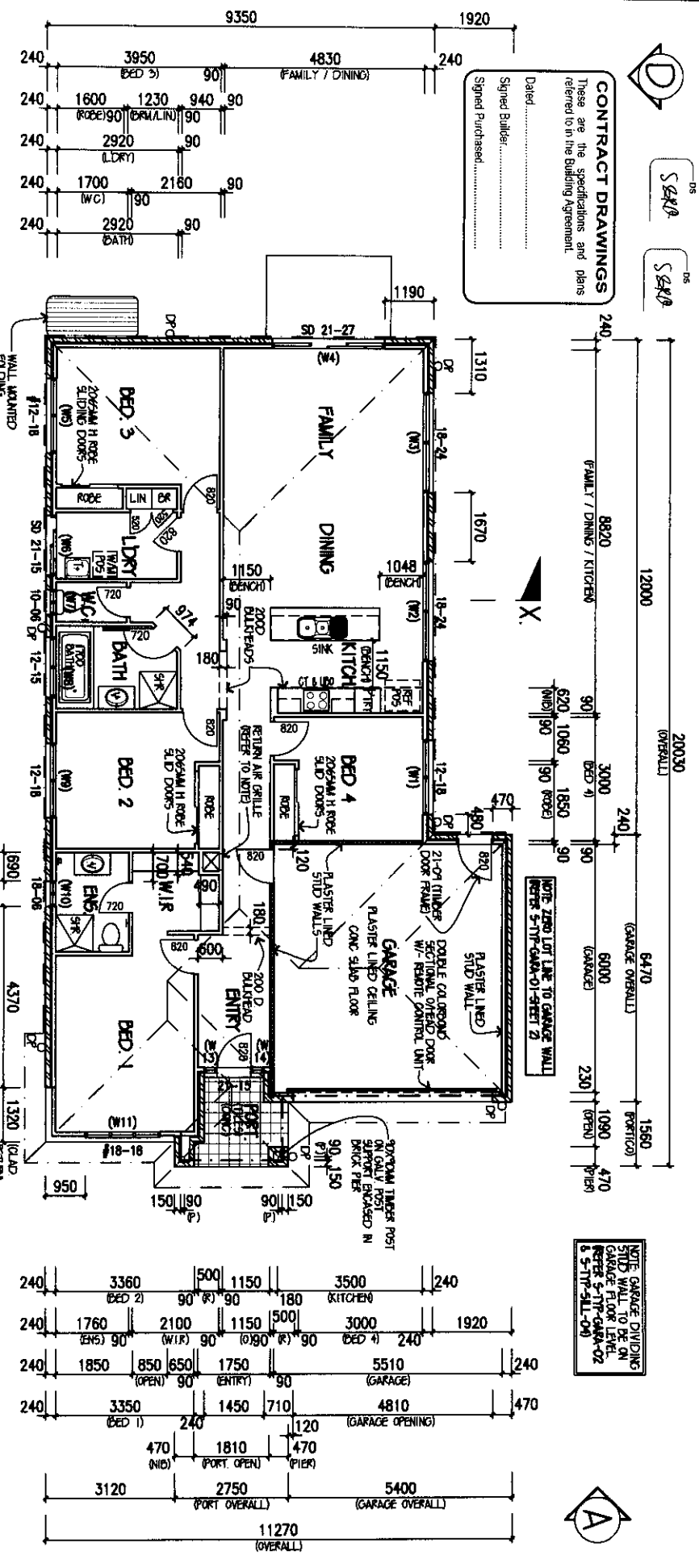

NOTE: GARAGE DIVIDING STUD WALL TO BE ON GARAGE FLOOR LEVEL. REFER 5-TTP-GARA-02 & 5-TTP-511-09

IMPORTANT NOTE:
 PROVIDE SELECTED TIMBER LAMINATE FLOORING TO ENTRY, ENTRY PASSAGE, KITCHEN, WIP, DINING, FAMILY. ALL REMAINING AREAS TO BE SELECTED CARPET (EXCLUDING WET AREAS).



NOTES:
 * VERIFY DIMENSIONS AND PRECEDENCE OVER SCALE FLOOR PLAN DIMENSIONS ARE TO FINISH SIZE ONLY.
 * WINDOW SIZES SHOWN ARE STARTER FRAME SIZES. ALL GLAZING TO COMPLY WITH AS 1288-2006 GLASS IN BUILDINGS & AS 4685-2012 FIRE WINDOWS.
 * ALL DOORS TO BE DOWN SW. 1500 W/DO BROWKROW.
 * ALL WET AREAS TO BE FINISHED IN ACCORDANCE WITH NCC 3.6.3.
 * INTERNAL, FINISH DIMENSIONS TO COMPLY WITH & BE INSTALLED IN ACCORDANCE WITH NCC 3.6.12 & 6.5/AS 4200.1 & AS 4200.2
 * ALL EXPOSED RISERS AND RAKEWOOD, DATED TO OUTSIDE AIR W/ ACC 3.6.1.3
 * ALL EXPOSED RISERS OR WALL VENTS IN ACCORDANCE WITH NCC 3.6.1.3

LEGEND:
 * LINE DRAWING WALL
 * WALL UNDER SHIP TO BE BUILT AFTER STAKE
 * 75MM RYS BOARD TO BE TO STUD/W/STAKE OVER
 * 75MM RYS BOARD TO BE TO STUD/W/STAKE OVER
 * 75MM RYS BOARD TO BE TO STUD/W/STAKE OVER

AREAS:	DESIGN:	HAZEL 21
GND FLR: 15150 SQM	FACADE RIVA	CELING 24 R
GARAGE: 5640 SQM	GARAGE DOUBLE	LOCATION F
PORCH: 440 SQM	FLOOR PLAN	
V16HZ21R1V51		
SUBTOTAL: 15150 SQM	TOTAL: 17241 SQM	METRICON TAKES OWNERS COPYRIGHT IN THIS DRAWING. UNAUTHORIZED USE, REPRODUCTION OR MODIFICATION IS PROHIBITED AND WILL BE PROSECUTED.
1621 SQM	2071 SQM	

AREAS:	DESIGN:	HAZEL 21
GND FLR: 15150 SQM	FACADE RIVA	CELING 24 R
GARAGE: 5640 SQM	GARAGE DOUBLE	LOCATION F
PORCH: 440 SQM	FLOOR PLAN	
V16HZ21R1V51		
SUBTOTAL: 15150 SQM	TOTAL: 17241 SQM	METRICON TAKES OWNERS COPYRIGHT IN THIS DRAWING. UNAUTHORIZED USE, REPRODUCTION OR MODIFICATION IS PROHIBITED AND WILL BE PROSECUTED.
1621 SQM	2071 SQM	

metricon invest
 501 Blackburn Road, Mount Waverley, Vic 3149
 P.O. Box 857, Mount Waverley, Vic 3149
 Telephone 03 9915 5777 Fax 03 9222 5143
 Building Practitioner Reg. No. 08-18079 A.C.L. 005 106 782
 © COPYRIGHT 2008 REPRODUCTION FORBIDDEN

OWNER: **MR. S. & R. ODHAVJI**
 LOT 7510 GILLESPIE AVENUE
WERRIBEE
 JOB NO: 750704 DATE: 22/11/21
 E.C. DATE: DD MM YYY YST VER: 01/07/2021
 PERMIT NO:
 DRAWN: PG4 CHECKED: SHEET: 2 of 2