

Statement of Information

Single residential property located in the Melbourne metropolitan area

Section 47AF of the Estate Agents Act 1980

Property offered for sale

Address
Including suburb and
postcode

5/40 SYCAMORE GROVE BALACLAVA VIC 3183

Indicative selling price

For the meaning of this price see consumer.vic.gov.au/underquoting (*Delete single price or range as applicable)

Single Price

\$395,000

or range
between

&

Median sale price

(*Delete house or unit as applicable)

Median Price

\$562,500

Property type

Unit

Suburb

Balaclava

Period-from

01 Jun 2023

to

31 May 2024

Source

Corelogic

Comparable property sales (*Delete A or B below as applicable)

A* These are the three properties sold within two kilometres of the property for sale in the last 6 months that the estate agent or agent's representative considers to be most comparable to the property for sale.

Address of comparable property

Price

Date of sale

1/130 ALMA ROAD ST KILDA EAST VIC 3183	\$395,000	03-Apr-24
5/27 SYCAMORE GROVE BALACLAVA VIC 3183	\$385,000	12-Jan-24
15/47 BRIGHTON ROAD ST KILDA VIC 3182	\$372,000	28-May-24

OR

B* The estate agent or agent's representative reasonably believes that fewer than three comparable properties were sold within two kilometres of the property for sale in the last 6 months.

This Statement of Information was prepared on: 14 June 2024

Tracy Paus
 P (03) 9066 4812
 M 0439 766 175
 E tracypaus@mcgrath.com.au

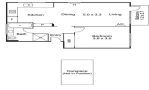

**1/130 ALMA ROAD ST KILDA EAST
 VIC 3183**

Sold Price **\$395,000** Sold Date **03-Apr-24**

1 1 1

Distance **1.37km**



**5/27 SYCAMORE GROVE
 BALACLAVA VIC 3183**

Sold Price **\$385,000** Sold Date **12-Jan-24**

1 1 1

Distance **0.08km**



**15/47 BRIGHTON ROAD ST KILDA
 VIC 3182**

Sold Price ^{RS} **\$372,000** ^{UN} Sold Date **28-May-24**

1 1 1

Distance **0.8km**

RS = Recent sale **UN** = Undisclosed Sale

DISCLAIMER Whilst all reasonable effort is made to ensure the information in this publication is current, CoreLogic does not warrant the accuracy or completeness of the data and information contained in this publication and to the full extent not prohibited by law excludes all for any loss or damage arising in connection with the data and information contained in this publication.

The State of Victoria owns the copyright in the Property Sales Data and reproduction of that data in any way without the consent of the State of Victoria will constitute a breach of the Copyright Act 1968 (Cth). The State of Victoria does not warrant the accuracy or completeness of the Property Sales Data and any person using or relying upon such information does so on the basis that the State of Victoria accepts no responsibility or liability whatsoever for any errors, faults, defects or omissions in the information supplied.